



VOLUME XVI ■ NUMBER 7

# kitchens

Boasting smart and creative design, these small kitchens deliver big storage and style.

# see worthy

EXPANSION AND LIGHT CREATE





## A HARBOR OF STREAMLINED EFFICIENCY

WRITTEN BY THERESA MCTAMMANY  
PHOTOGRAPHS BY LAURIE LAMBRECHT  
STYLING BY ELIZABETH BOTERO

The assertive wood tones of the countertops call to mind teak and mahogany found on boats, but in this case, they're a more practical clear pine. Homeowner and boating enthusiast Adele Kapp chose the dark wood for its nautical overtones. She says the big challenge in maintaining the pine is remembering that these counters are not for cutting.



**ABOVE:** Open shelves take the place of wall cabinets. They reinforce the casual look and display loads of stuff, but they're also time savers. No cabinet doors to open and close eliminates steps during food prep and cleanup.



**ABOVE:** Hinged shutters govern the sunlight in lieu of curtains or blinds, swinging closed for a little privacy or open for more light. The unshuttered top half of the window lets natural light gush in throughout the day.

**A**dele Kapp is no stranger to small spaces. Her favorite pastime is sailing, and she admits that she is just as comfortable aboard a boat as she is on land. Therefore, it was no surprise that after purchasing a tiny four-room ranch in East Hampton, New York, she wanted everything shipshape—including the kitchen, which hadn't been touched in 50 years. "I didn't want anything superfluous," says Adele. "I'm very minimal in my taste. I don't like clutter; I like things to have a place."

To help square things away, she hired architect Erica Broberg of Erica Broberg Architect in East Hampton to adapt the tight space to her breezy, pared-down lifestyle. Broberg approached the small lot with no room for expansion as though it were an apartment, focusing on interior changes. "Since we were stuck with the existing footprint, we chose to open the floor plan up and make the space as efficient and livable as possible," she says.

Finding space for the dining room Adele desperately wanted was priority number one. Stealing 170 square feet from the adjoining garage yielded ample room for a din-

ing room table and chairs. The next step, removing a wall that stood as a barrier between the kitchen and the living room, improved the layout and immediately opened up the space. To add character and architectural interest, Broberg raised the ceiling and added a shed dormer overhead, flooding the room with light.

Having created a blank space, Broberg pulled a switcheroo, moving the kitchen to the front of the house. She then installed a two-sided fireplace that serves both living and dining rooms. "It was a totally boring shoebox of a house," Adele admits. "Adding the fireplace and the dormer window was brilliant. The entire room was transformed—it now has charm."

Adele chose wood countertops, largely for ease of maintenance and durability, although the nautical angle

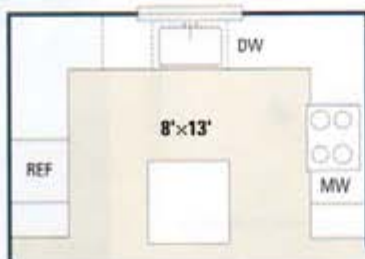

**LEFT:** The kitchen layout is a textbook example of a work triangle, with the island serving as food-prep central. The size, too, is absolutely perfect for a single cook with occasional guests.

## design points



### TIPS FOR A SMART SMALL SPACE

■ Broberg stashed cleaning supplies in a tall cabinet located outside the main work triangle. The side of that cabinet has shelves for cookbooks and snappy display items.

■ A monochromatic color scheme provides visual continuity and makes the space seem larger. In the kitchen, the Shaker-style recessed-panel cabinets are painted in the same warm khaki color as the walls in the rest of the house. "It's a color I use a lot," Broberg says. Even the massive custom refrigerator panels get into the act.





**Black cooking appliances contrast with off-white cabinets and wood countertops. White would have been unbearably bright, and stainless steel would have been out of character in the laid-back room.**

SEE BUYING GUIDE FOR DETAILS



**ABOVE: A modest island nevertheless has enough space for two people to sit comfortably. Just as important as cutting down on the fuss factor was making sure the kitchen could accommodate friends dropping by. The island seating is a big help in that department.**

didn't totally escape her notice. "You'll find mahogany or teak on boats, but these are ordinary clear pine, which holds up just as well and is more practical," she says. "You just have to remember it's not a cutting board." Pine appears again on a small island that provides seating for two. Adele calls this her favorite feature. "My friends can sit on the other side and watch me chop."

Built-in storage accessories such as plate racks lend functional tidiness, not unlike that on a boat. Adele resisted hanging cabinets, preferring the look of open shelves. For lower units, she opted for full-extension drawers that glide open easily rather than cupboards equipped with pullout shelves. "It doesn't make sense to perform two separate actions, when one would do."

The refreshed space—spare yet stylish—meshes well with Adele's seagoing sensibilities and laid-back lifestyle. The streamlined cooking and cleaning processes allow her to focus attention on her guests, rather than the food. "Every event is a special event because of my friends," she says. "That's the way it should be." ♦